

VERTICE 11			VERTICE 12			VERTICE 13			VERTICE 14			VERTICE 15			VERTICE 16		
XT1 = -38.967	XV = -68.190	XT2 = -80.222	XT1 = -89.927	XV = -92.321	XT2 = -118.645	XT1 = -165.097	XV = -204.207	XT2 = -227.373	XT1 = -246.723	XV = -262.066	XT2 = -260.821	XT1 = -259.382	XV = -280.287	XT2 = -340.426	XT1 = -389.510	XV = -380.510	XT2 = -323.326
YTI = 271.910	YV = 288.732	YT2 = 320.309	YTI = 327.396	YV = 355.011	YT2 = 353.100	YTI = 355.021	YV = 356.638	YT2 = 388.190	YTI = 414.348	YV = 435.442	YT2 = 461.334	YTI = 461.334	YV = 491.658	YT2 = 574.443	YTI = 574.443	YV = 615.586	YT2 = 631.024
SVC1 = 0.000	AV = 156.544	SVC2 = 0.000	SVC1 = 0.000	AV = 165.840	SVC2 = 0.000	SVC1 = 25.000	AV = 142.944	SVC2 = 25.000	SVC1 = 16.251	AV = 156.625	SVC2 = 16.251	SVC1 = 16.251	AV = 147.779	SVC2 = 16.251	SVC1 = 20.000	AV = 56.965	SVC2 = 20.000
KTCl = -38.967	AD = 43.455	KTCl = -80.222	KTCl = -89.927	AD = 74.159	KTCl = -118.645	KTCl = -109.069	AD = 57.056	KTCl = -211.132	KTCl = -255.609	AD = 43.375	KTCl = -260.920	KTCl = -260.920	AD = 52.291	KTCl = -269.606	KTCl = -251.958	AD = 143.350	KTCl = -342.547
YTC1 = 271.910	KC = 8.534	YTC2 = 320.309	YTC1 = 327.396	KC = -120.298	YTC2 = 353.100	YTC1 = 357.933	KC = -175.273	YTC2 = 369.259	YTC1 = 428.133	KC = -211.049	YTC2 = 477.566	YTC1 = 490.813	KC = -310.593	YTC2 = 500.493	YTC1 = 598.559	KC = -331.060	YTC2 = 616.197
AC1 = 0.000	YC = 354.683	AC2 = 0.000	AC1 = 0.000	YC = 313.134	AC2 = 0.000	AC1 = 37.081	YC = 410.961	AC2 = 37.081	AC1 = 28.505	YC = 480.813	AC2 = 28.505	AC1 = 28.505	YC = 471.836	AC2 = 28.505	AC1 = 20.976	YC = 597.434	AC2 = 20.976
R = 95.000			R = 40.000			R = 50.000			R = 50.000			R = 50.000			R = 22.000		
SVRC = 64.847			SVRC = 46.596			SVRC = 24.288			SVRC = 17.818			SVRC = 24.770			SVRC = 29.464		
SVL = 64.847			SVL = 46.596			SVL = 74.288			SVL = 50.320			SVL = 37.272			SVL = 69.464		

VERTICE 17			VERTICE 18			VERTICE 19			VERTICE 20		
XT1 = -307.494	XV = -297.787	XT2 = -288.196	XT1 = -269.718	XV = -233.679	XT2 = -217.749	XT1 = -216.117	XV = -185.292	XT2 = -187.616	XT1 = -187.648	XV = -189.416	XT2 = -233.439
YTI = 622.529	YV = 623.452	YT2 = 621.687	YTI = 618.265	YV = 611.651	YT2 = 578.650	YTI = 575.268	YV = 511.411	YT2 = 582.281	YTI = 583.257	YV = 637.160	YT2 = 668.314
SVC1 = 0.000	AV = 192.376	SVC2 = 0.000	SVC1 = 22.174	AV = 140.216	SVC2 = 22.174	SVC1 = 0.000	AV = 26.543	SVC2 = 0.000	SVC1 = 28.000	AV = 141.299	SVC2 = 28.000
KTCl = -307.494	AD = 17.623	KTCl = -288.196	KTCl = -248.313	AD = 59.781	KTCl = -228.812	KTCl = -216.117	AD = 173.456	KTCl = -187.616	KTCl = -190.192	AD = 58.706	KTCl = -211.594
YTC1 = 622.529	KC = -300.868	YTC2 = 621.687	YTC1 = 616.685	KC = -267.958	YTC2 = 597.815	YTC1 = 575.268	KC = -262.608	YTC2 = 582.281	YTC1 = 611.03	KC = -268.471	YTC2 = 620.859
AC1 = 0.000	YC = 352.843	AC2 = 0.000	AC1 = 33.297	YC = 566.705	AC2 = 0.000	AC1 = 0.000	YC = 591.799	AC2 = 0.000	AC1 = 47.229	YC = 594.600	AC2 = 47.329
R = 70.000			R = 50.000			R = 19.000			R = 80.000		
SVRC = 19.378			SVRC = 24.778			SVRC = 40.870			SVRC = 45.772		
SVL = 19.378			SVL = 69.126			SVL = 40.870			SVL = 101.772		

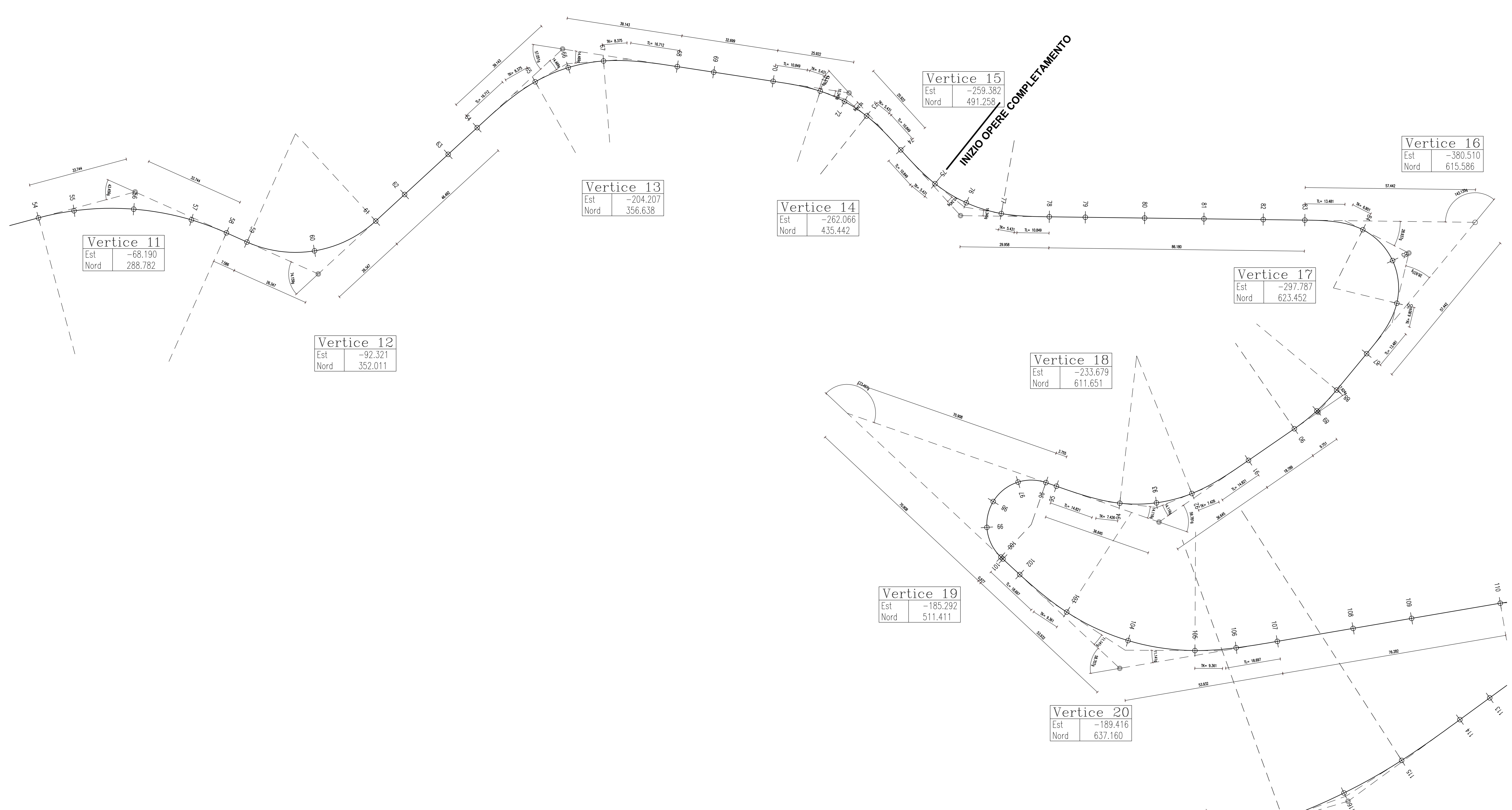



Provincia di Chieti

Settore Lavori Pubblici

LAVORI DI SISTEMAZIONE STRADA PROVINCIALE S.S. 650
FONDO VALLE TRIGNO SCHIAVI D'ABRUZZO

III° Lotto Funzionale

PLANIMETRIA DI TRACCIAMENTO 2 DI 4
DA VERTICE 11 A VERTICE 20

<p>STUDIO MONTEPARA</p> <p>ING. ANTONIO MONTEPARA</p> <p>PROFESSIONISTA</p> <p>TEL. 0871 307443</p> <p>WWW.MONTEPARA.IT</p>	<p style="text-align: center;">Il Progettista</p> <p style="text-align: center;">Prof. Ing. Antonio Montepara</p> <div style="text-align: center;">  </div> <p style="text-align: center;">Responsabile Unico del Procedimento</p>	<p style="text-align: center;">TAVOLA</p> <p style="text-align: center; font-size: 2em;">7.2</p> <p style="text-align: center;">SCALA : 1:500</p> <p style="text-align: center;">DATA : 17/03/2014</p>
--	---	--

Revisione	Data	Descrizione	Redatto	Controllato	Approvato
REV0					
REV1					
REV2					